

ATL® Table of Contents

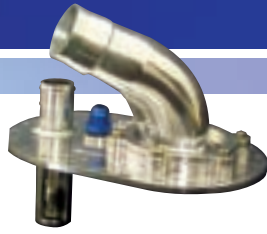

ATL Fill Valves

21 Quick Fill & Regular Fill Valve Assemblies, Drilled Plates & Blanks



ATL Marine Fuel Cell Bladders

25 Race Boat, Defense-Department Bladders & PETRO-FLEX™ Range Extension Bladders



ATL Necks, Caps & Valves

22 Fill Necks, Fill Valves, Caps and Vent Valves



ATL Advanced Defense & Industrial Products

26 Bulk Fuel Bladders, Air Cells, Water Cells, Drums & Inflatables



ATL Parts & Accessories

23 Level Senders, Gauges, Hoses, Racing Accessories



Important Information

27 Safety & Performance Reminders

PLEASE READ



ATL Refueling Equipment

24 Dry Breaks, Dump Cans & Refueling Valves



ATL #1 FOR FORTY YEARS

Introduction

ATL® Safety Fuel Tanks

40 Years of Development!



ATL is a proud and venerable company, having produced advanced fuel cell bladders for 40 years. While other firms have come and gone, leaving their customers stranded, ATL has endured by way of its technological superiority, unparalleled service, equitable pricing and plain old hard work!

Founded by engineer racers in a small garage, ATL has grown to a global operation with factories in North America and Europe, plus a thousand trusted Distributors and OEM's around the World.

ATL has not only become the "winner's choice", we have become the entire field's choice! Especially in NASCAR, Formula 1, Late Models, World Rally, Off Shore, Prototypes and Vintage racing, ATL Safety Cells dominate each entire category.

ATL produces more racing cells than all of its competitors combined. And, the company's market has expanded to include Off-Road, Drag, Time-Attack, Drifting, Rally, Rock Crawling Aircraft, Navy Vessels and Armored Vehicles too.

Why are we so successful? Because ATL never slows its development of both safety and performance features. While offering the highest puncture resistance, best explosion suppression and greatest roll-over protection, ATL also provides the lightest weight, fastest fill, highest capacity and best fuel scavenging of any racing cell.

There are only a handful of companies whose products provide the racer with both performance and safety; ATL is pleased to be one of those few!